

FX_{2N}-GM-65EC EXTENSION CABLE USER'S GUIDE

Introduction

The FX_{2N}-GM-65EC cable is used to connect the FX_{2N} or FX_{2NC} series programmable controllers (PLC) to the FX_{2N} series pulse generation units (PGU) at a distance 650 mm. For the construction of the optimum PC system the following points should be observed when using this extension cable.

1. Method of cable connection

The PLC and the PGU are connected with the FX_{2N}-GM-65EC.

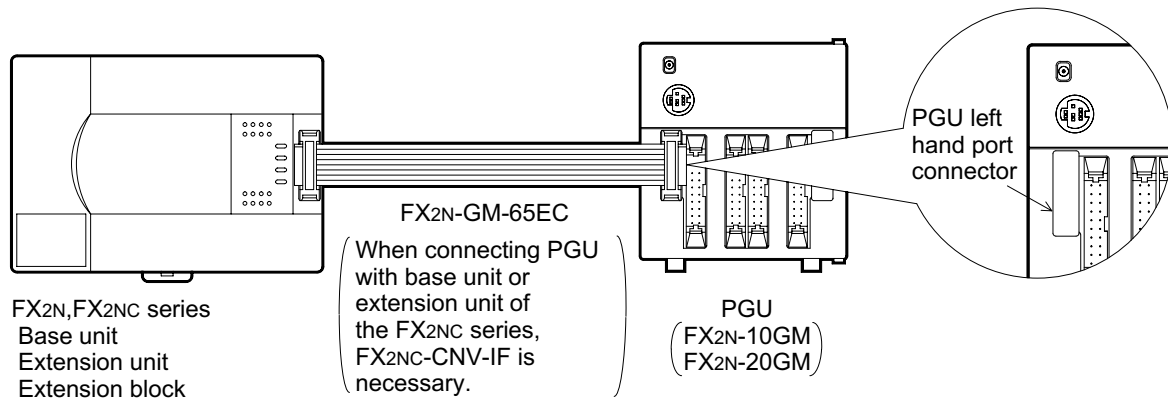

2. System configurations

Only one FX_{2N}-GM-65EC can be used per system.

However the positioning of FX_{2N}-GM-65EC is completely flexible.

The right hand port of the PLC must be connected to the left hand port of the PGU.

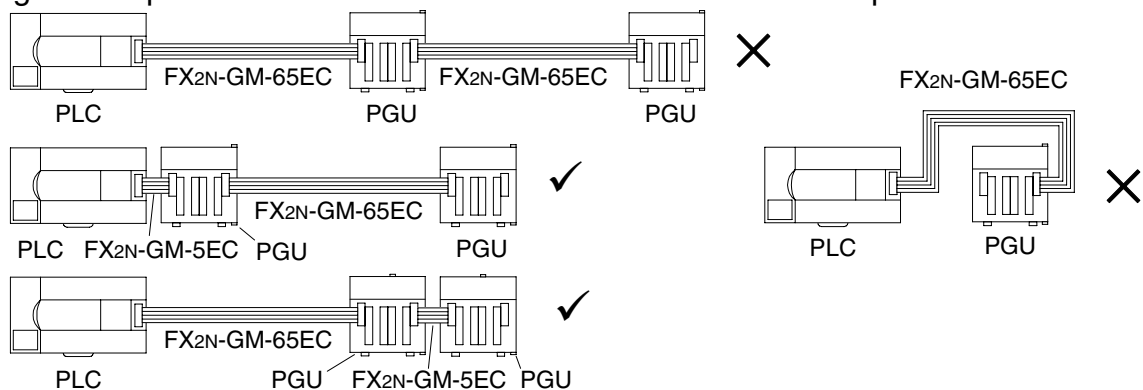

3. Miscellaneous

Practice of laying cables well away from power lines should be observed. Under some conditions excess electrical noise may make it necessary to filter any local power supplies.